



One The Elephant

1 St Gabriel Walk, SE1 6FF

£1,269 Per Week



3



3



1



B

Floor Plan

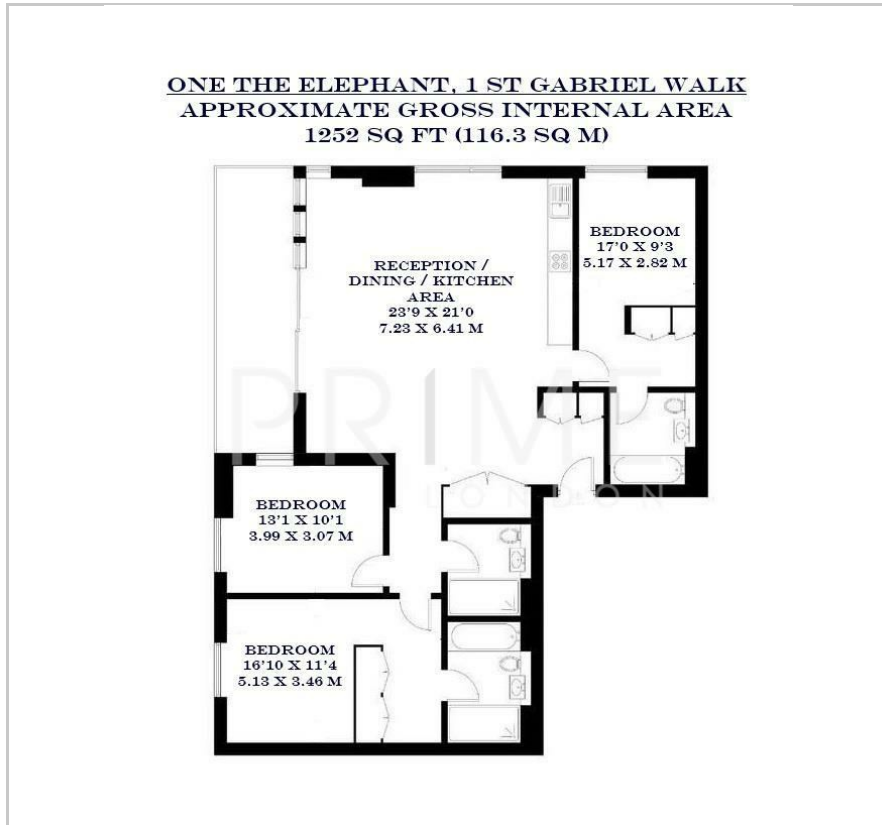

Area Map

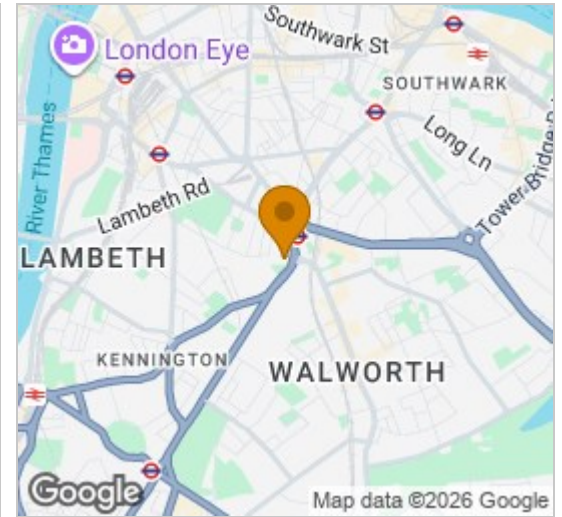

Energy Efficiency Graph

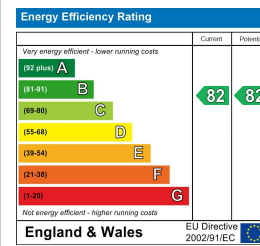

Viewing

By appointment. Contact us on 0207 928 6663 if you wish to arrange a viewing appointment for this property, or require further information.

- Three bedroom apartment
- 1252 sq ft (116.3 sqm)
- Private balcony with exceptional views
- Furnished
- 24 hour concierge
- Excellent transport links



This stunning high floor three bedroom apartment, spanning 1,252 sq ft (116.3 sqm), perfectly situated within the highly sought-after One The Elephant development, is available to lease through Prime London.

This property offers a spacious open-plan living and dining area with a modern kitchen, leading onto a spacious private balcony with exceptional views. The property further benefits from three well proportioned bedrooms two with built-in wardrobes and two ensuites, with an additional guest bathroom.

Residents of One The Elephant enjoy an array of exclusive amenities, including a 24 hour concierge, a beautifully designed residents' lounge, a 'green roof', pool, gym, and a café.

The vibrant Elephant and Castle neighbourhood boasts a rich selection of bars, restaurants, and essential amenities, with a brand-new shopping district currently under construction.

Conveniently located near Elephant and Castle station, this property offers excellent transport links with both Underground and rail services.



These particulars, whilst believed to be accurate are set out as a general outline only for guidance and do not constitute any part of an offer or contract. Intending purchasers should not rely on them as statements of representation of fact, but must satisfy themselves by inspection or otherwise as to their accuracy. No person in this firm's employment has the authority to make or give any representation or warranty in respect of the property.